

Servo Spindle Unit

FD33S-80

FD33S-80 Specification	
Drilling Capacity	Ø5mm(Mild steel)
Tapping Capacity	M6(Mild steel)
Spindle Nose Type	ER16- Ø10 , JT1- Ø6.5 , JT2- Ø10
Stroke	80mm
Feeding Power	0.4KW(Servo)
Spindle Power	1/2HP(AC motor);0.75kw(Servo motor)
Max. Revolution/Minute	6,000 rpm
Weight	16kg(FD33SS-Servo motors not included) 22kg(FD33S- Servo motor not included)

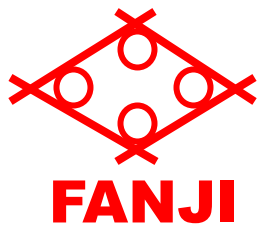



Servo Spindle Unit

FD33S-80

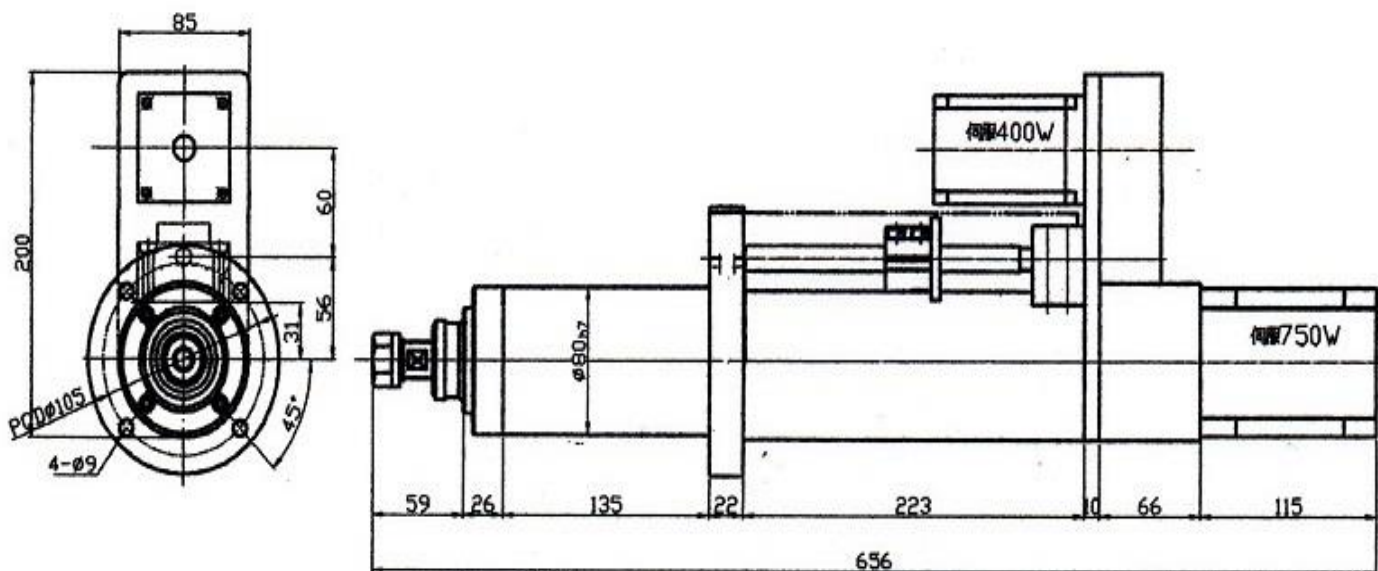

FD33S-80-ER16

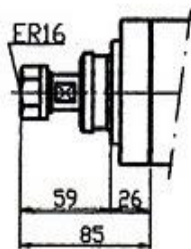

FD33S-80-JT1

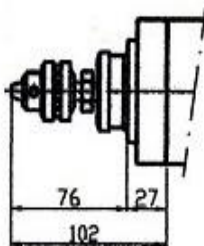

FD33S-80-JT2

